

Installation Instructions for 159050 TBI Fuel Pressure Regulator

Installation Instructions:

1. Remove the Fuel Meter Cover and Injector Housing.
2. Remove the Fuel Pressure Regulator and install the JEGS billet regulator; reusing the factory spring and diaphragm. **Note:** Inspect the diaphragm for holes or tares and replace if needed.
3. If using an O.E. throttle body drill a hole in the lower half of the injector housing to access the allen-head adjustment screw and jam nut. See Figure 1.
4. Re-assemble the throttle body.
5. Start the vehicle and set the regulator to the desired fuel pressure with a 1/8" allen wrench.
6. Be sure to check for any leaks before driving the vehicle.

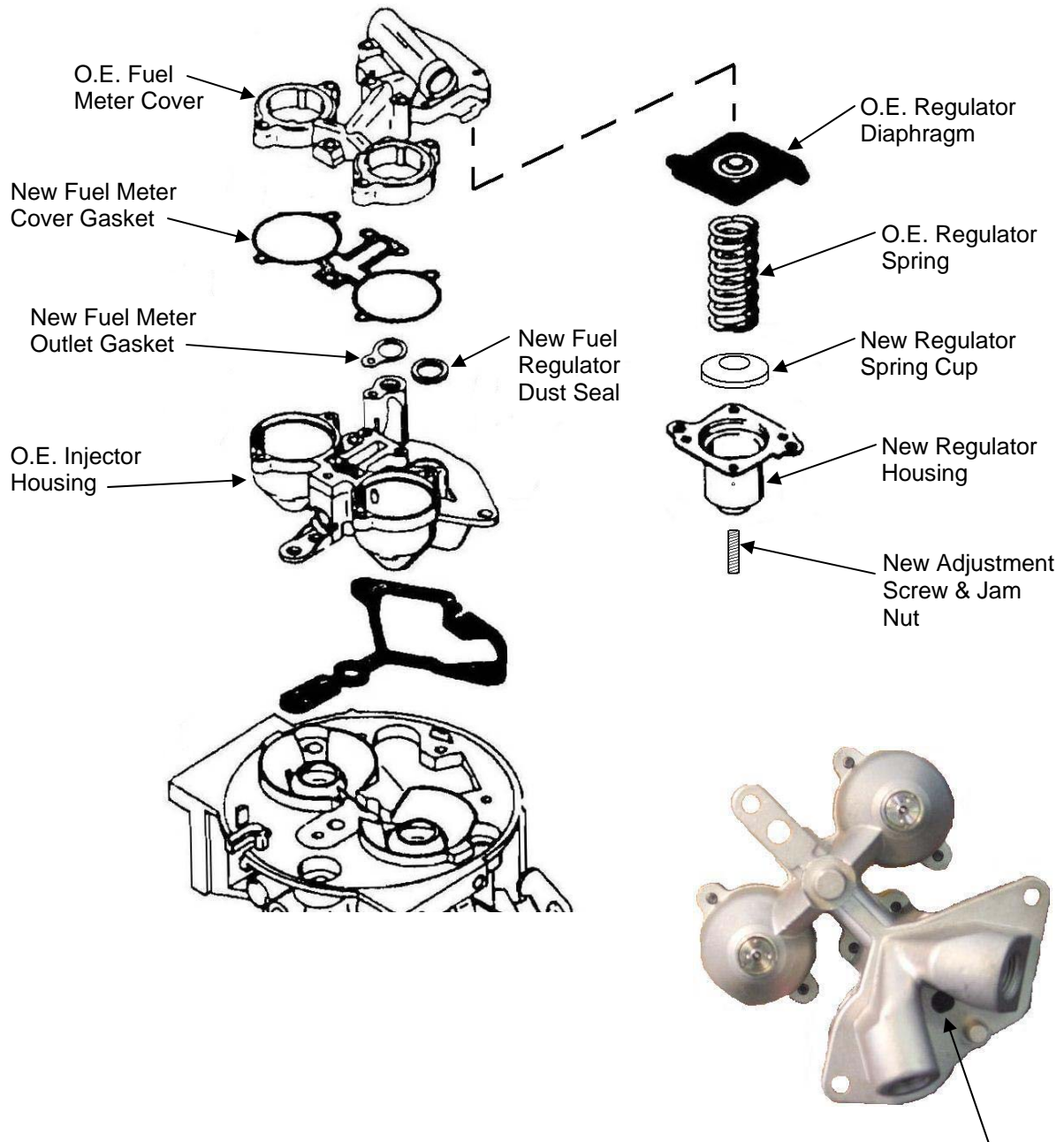

Figure 1